

405-47-01

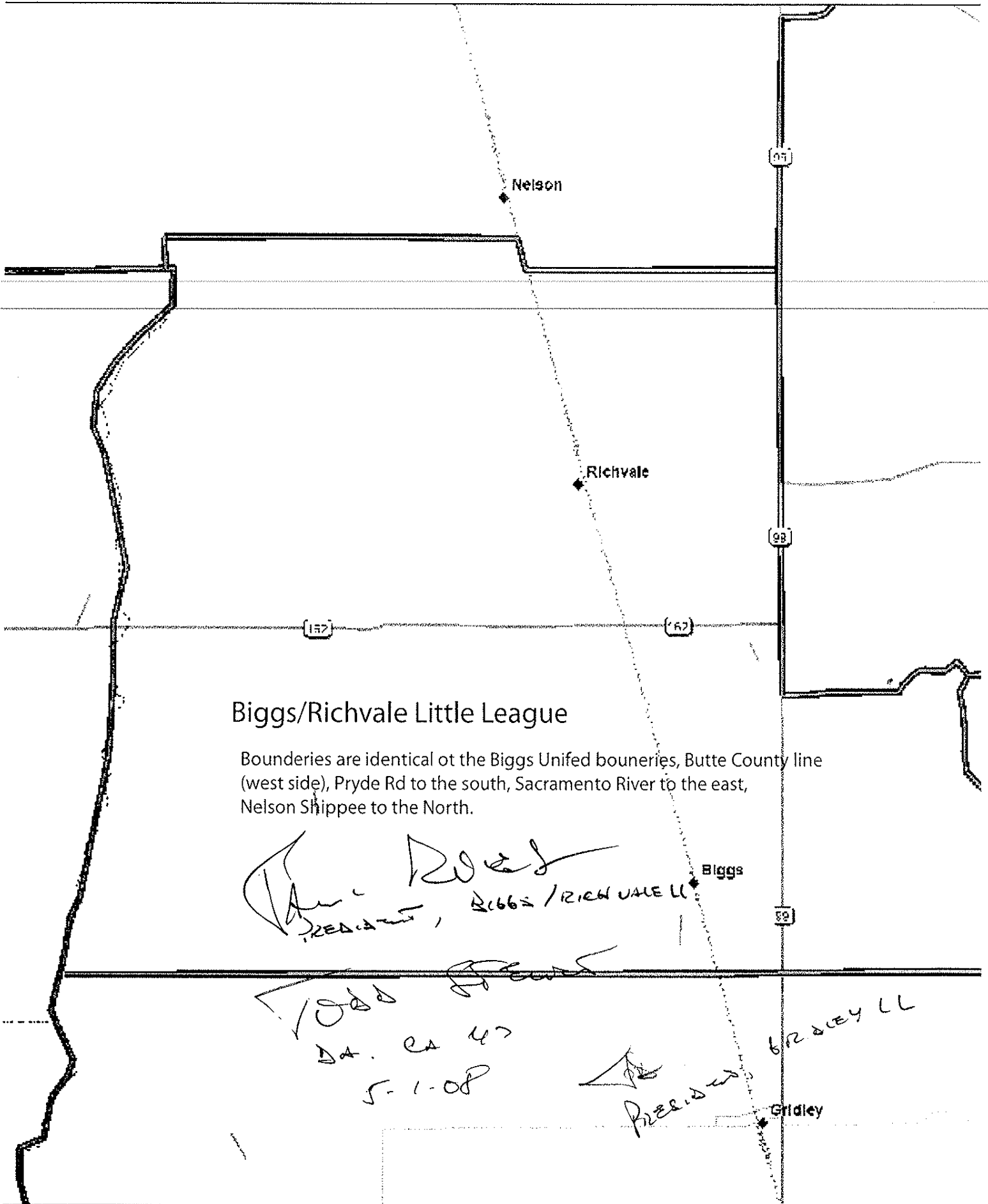

Biggs/Richvale Little League

Boundaries are identical to the Biggs Unified boundaries, Butte County line (west side), Pryde Rd to the south, Sacramento River to the east, Nelson Shippee to the North.

[Signature]
 PRESIDENT, Biggs/RICHVALE LL

[Signature]
 DA. CA 47
 5-1-08

[Signature]
 PRESIDENT BRIDLEY LL